

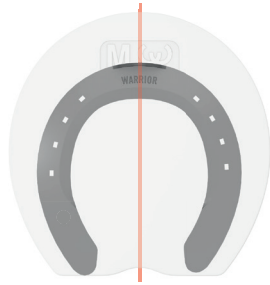

INSTRUCTIONS SUPPORT PAD

- 1 HORSESHOE ALIGNMENT**
PLACE THE HORSESHOE TOWARDS THE BOTTOM OF THE SUPPORT PAD



- 2 REFERENCE**
DRAWING THE HORSESHOE CONTOUR INCLUDING TOE OR SIDE CLIPS



- 3 CUT**
THE SUPPORT PAD CAN BE EASILY CUT WITH LEATHER SCISSORS OR OTHER CUTTING TOOLS

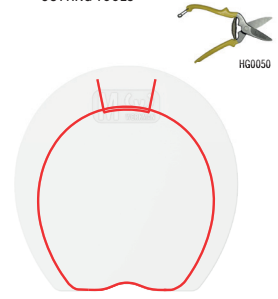

- 4 DRILLING**
ØDRILL 5.5MM HOLES FOR MOUNTING THE COPPER RIVETS



PAY ATTENTION! MAKE SURE THAT THE SOLE DOES NOT BULGE

- 5 RIVETS**
FOR FASTENING YOU CAN USE THE WERKMAN COPPER RIVETS



PAY ATTENTION! BEVEL SIDE OF RIVET TO SOLE SIDE

- 6 CONFIRMATION**
THE COPPER RIVETS CAN NOW BE CUT OFF



PAY ATTENTION! LEAVE ENOUGH LENGTH TO FLATTEN THE COPPER RIVETS

HOOF SOLUTIONS SUPPORT PAD

- 1 ACT 1**
PLACE THE RELEVANT HOOF CARE SOLUTION AT THE ENDS OF THE BRANCHES OF THE HORSESHOE

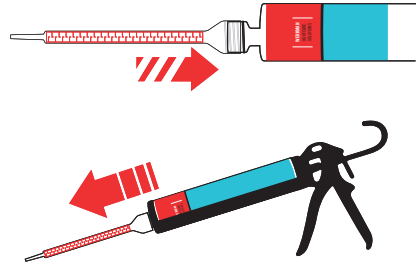

PAY ATTENTION: RISK OF DRYING OUT OF THE TIP

- 2 ACT 2**
FIRST FILL THE SIDES WITH THE RELEVANT HOOF CARE SOLUTION, WORK FROM THE OUTSIDE IN

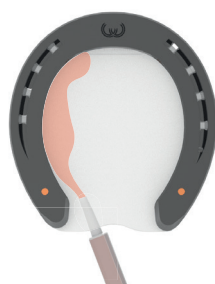

- 3 ACT 3**
THEN FILL THE ENTIRE SOLE, PAY ATTENTION TO AIR INCLUSIONS!





INSTRUCTIONS PRECISION PAD

1 HORSESHOE ALIGNMENT
EDGES OF THE PRECISION PAD MARK THE HORSESHOE ALIGNMENT

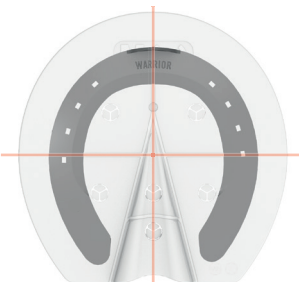

2 REFERENCE
DRAWING THE HORSESHOE CONTOUR INCLUDING TOE OR SIDE CLIPS

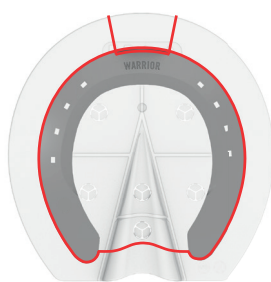

3 CUT
THE SUPPORT PAD CAN BE EASILY CUT WITH LEATHER SCISSORS OR OTHER CUTTING TOOLS

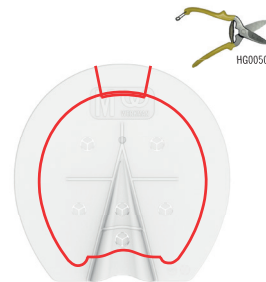

4 DRILLING
ØDRILL 5.5MM HOLES FOR MOUNTING THE COPPER RIVETS

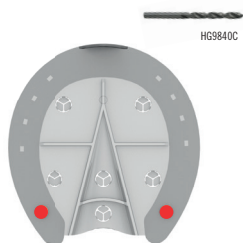

PAY ATTENTION! MAKE SURE THAT THE SOLE DOES NOT BULGE

5 RIVETS
FOR FASTENING YOU CAN USE THE WERKMAN COPPER RIVETS



PAY ATTENTION! BEVEL SIDE OF RIVET TO SOLE SIDE

6 CONFIRMATION
THE COPPER RIVETS CAN NOW BE CUT OFF

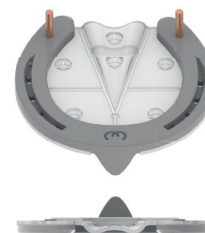

PAY ATTENTION! LEAVE ENOUGH LENGTH TO FLATTEN THE COPPER RIVETS

HOOF SOLUTIONS PRECISION PAD

1 POST MIXING TIPS
PLACE A MIXING TIP ON THE SCREW CONNECTION OF THE SEALANT PACKAGE AND PLACE THE ASSEMBLY IN THE CAULKING GUN

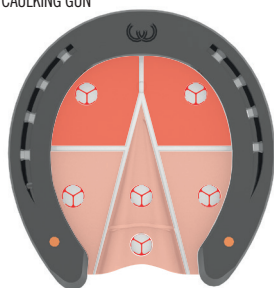

2 MIXING TIPS
SQUEEZE THE GUN A FEW TIMES UNTIL THE TWO COMPONENTS COME INTO CONTACT

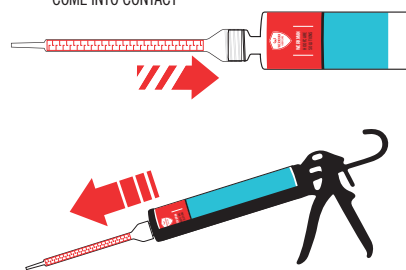

PAY ATTENTION: RISK OF DRYING OUT OF THE TIP

3 ACT 1
PLACE THE RELEVANT HOOF CARE SOLUTION IN ONE OF THE 7 FILLING HOLES AND START FILLING THE SOLE ON THE OUTSIDE



PAY ATTENTION! WORK FROM THE OUTSIDE IN BECAUSE OF AIR INCLUSIONS!

4 ACT 2
FILL THE EDGE SIDE OF THE AREA VERY SLOWLY, FIRST ALLOWING THE FILLING MATERIAL TO SET AGAINST THE EDGES OF THE PRECISION PAD

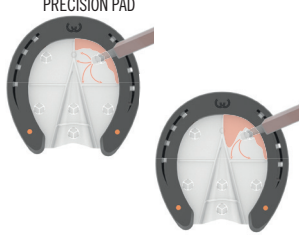

PAY ATTENTION! DEXTERITY REQUIRED! WORK QUICKLY BUT CONTROLLED!

5 ACT 3
NOW THAT A LARGER WALL HAS BEEN CREATED, THE AREA CAN BE COMPLETELY FILLED



PAY ATTENTION! DEXTERITY REQUIRED! WORK QUICKLY BUT CONTROLLED!